

Tutoring Service
for
Introductory Statistics A (GE122) and B (GE123)

Tutoring service is available in Building 11, Room 405 (Global Network Center), from 11 October 2017 to 25 January 2018, for those who are having difficulty with these courses. Times when tutors are available are indicated by ○.

Time	Monday	Tuesday	Wednesday	Thursday	Friday
09:00-10:30					
10:40-12:10		○	○	○ Only in Japanese	○
13:00-14:30		○	○	○ Only in Japanese	
14:45-16:15	○	○	○		
16:30-18:00					

Remark1: On 11/27 (Mon.), the opening hour becomes 10:40-12:10, 13:00-16:15.

Remark2: On exam days (11/28 Tue. and 1/25 Thu.), the opening hour becomes 10:40-12:10, 13:00-17:30.

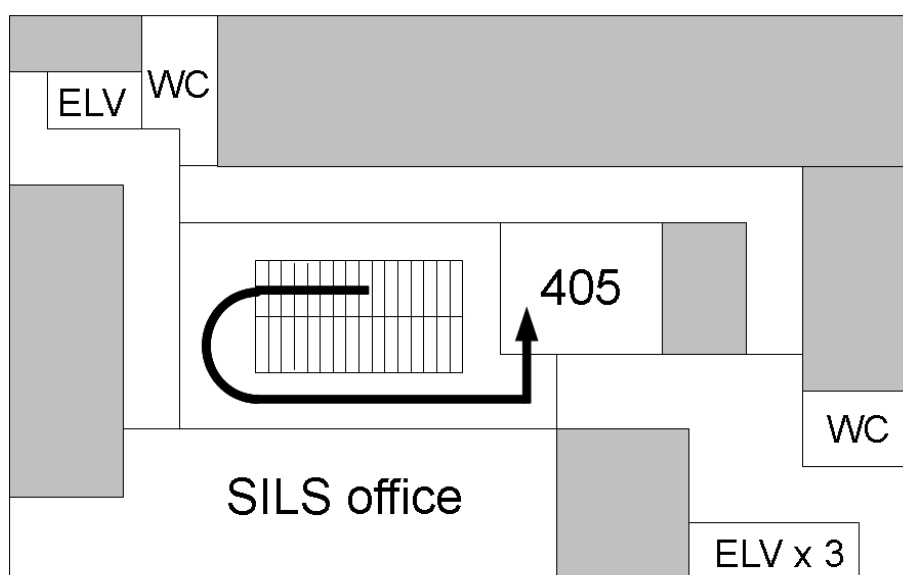

4F
Building 11, Room 405 (Global Network Center)