

Wireless LAN (Mac OS X 10.5-10.6)

Alumni (graduates) will not be able to connect to the intra-university networks.

INDEX

- I. Network Settings **1~3**
- II. Daily Use **4**
- III. Delete Network Setting **5~8**
(User Name and Password)

I. Network Settings

1

- (1) Click AirPort icon on menu bar.
- (2) Select Join Other Network.

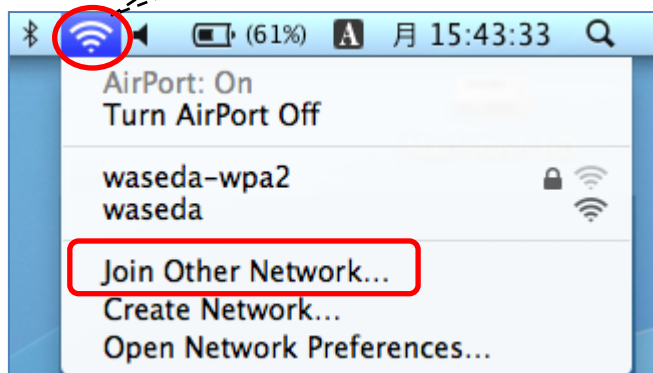

- (1) Select WPA2 Enterprise in Security.
- (2) Network Name is **waseda-wpa2**
- (3) Enter your Waseda ID or Waseda mail address and the password.
- (4) Click Join.

2



I . Network Settings

3

If Verify Certificate window appears, click Continue.

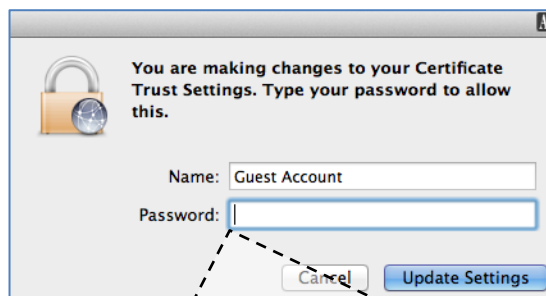

If this window appears, enter your username of Mac and the login password and click Update Settings.

- If cannot open web page, restart Safari or Mac.
- You can you check the location on IT service NAVI site.
http://www.waseda.jp/navi/e/network/wireless_new.html

Tech Info

- Network connections are restricted to some ports for security reason. So you may not use some softwares like messenger, mail client. If you want to use it, you have to use general purpose proxy. See <http://www.waseda.jp/navi/e/network/general-proxy.html>

II . Daily Use

4

Next time you use AirPort, click AirPort icon and select waseda-wpa2.

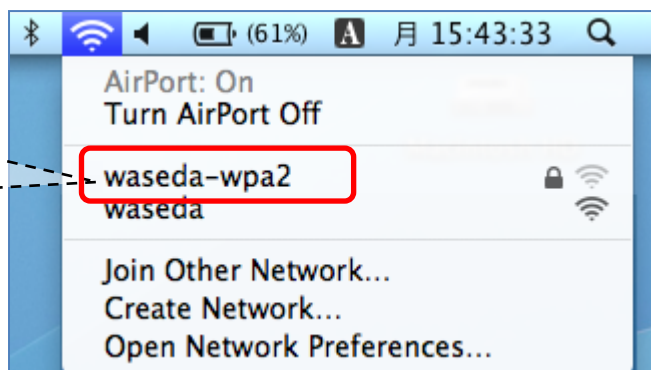

III. Delete Network Setting

Describes how to delete the wireless LAN network setting (User Name and Password) from your PC.

5

- (1) Click AirPort icon on menu bar.
- (2) Select Join Other Network.

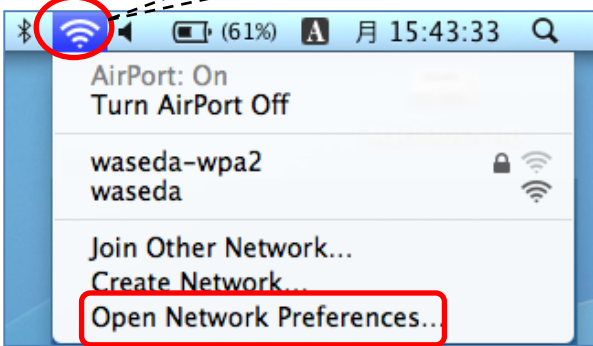

Select Auto.

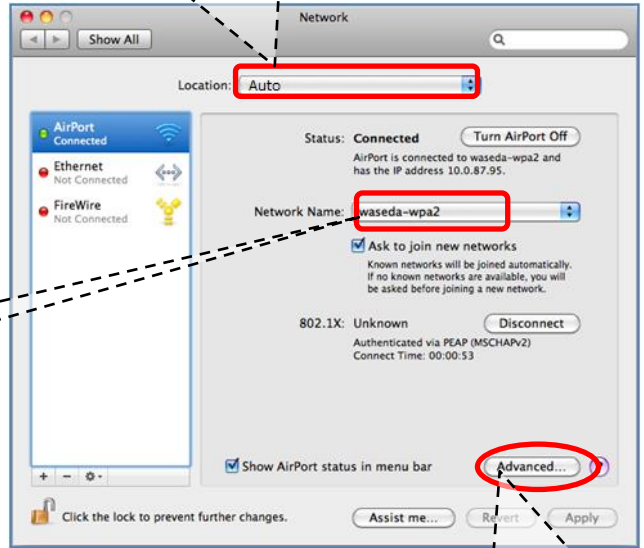

6

Select waseda-wpa2.

7

Click 802.1X.

Click Advanced.

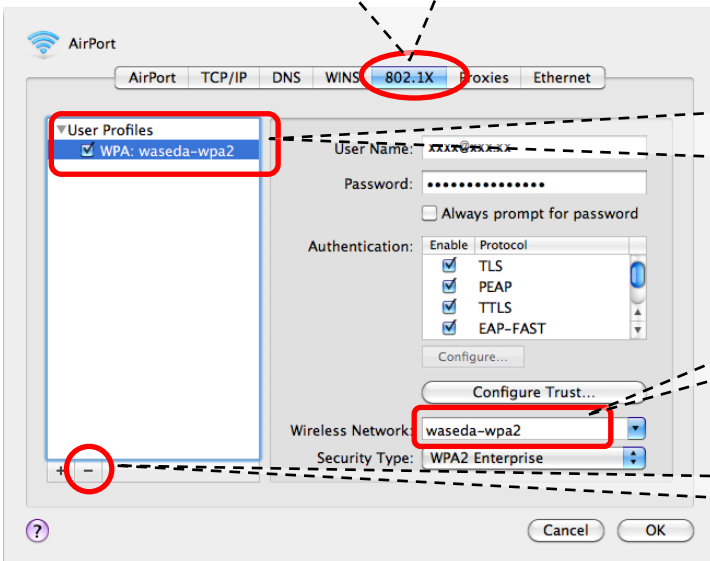

Click WPA: waseda-wpa2. If you cannot find WPA: waseda-wpa2, click ▾ before User Profiles.

Select waseda-wpa2.

Click “-”.

User Profile of waseda-wpa2 will be removed from the list.

III. Delete Network Setting

8

Click AirPort.

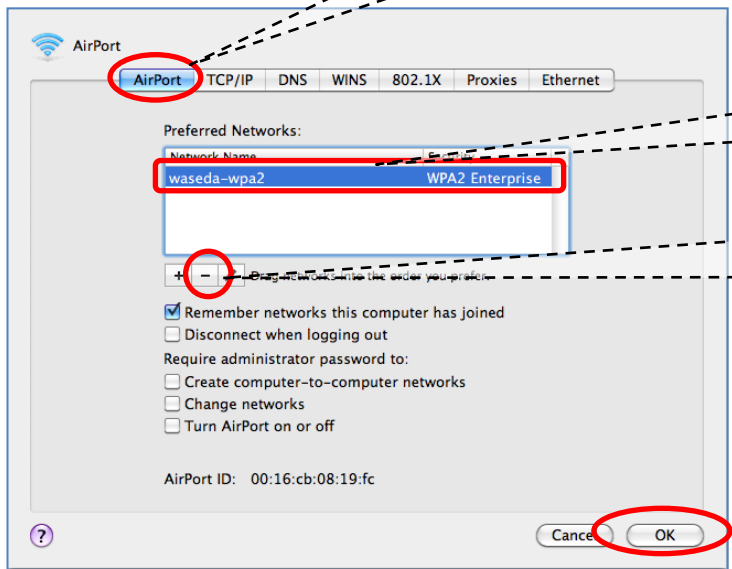

Select waseda-wpa2.

- (1) Click “-”.
- (2) Click OK.
- (3) Then click Apply.

Waseda-wpa2 will be removed from the list.